



HARTFIELD
PARISH
COUNCIL

NEWSLETTER

April 2009 Vol. 1 Issue No. 10



ANNUAL PARISH MEETING
27th April 2009 7.30pm
Hartfield Village Hall
Speaker from the High Weald
AONB.

MESSAGE FROM THE CHAIRMAN

It would appear that we are enjoying the start of a beautiful spring. I must say that the pots and planters on the High Street and the daffodils round the oak tree have been exceptionally beautiful this year. I would like to thank all the volunteers who keep our village looking so attractive. This issue of the newsletter marks the end of another year of the Parish Council. At the PC meeting in May, councillors can once again choose the committees they serve on and select their chairman. I would like to thank my fellow councillors for their dedication and hard work during the past year and I am grateful to Nancy Holmes for drawing together the newsletter bringing you some good news of progress on several projects of great interest to the parish. This can be seen in colour on our website www.hartfieldonline.com

I look forward to welcoming you all to the Annual Parish Meeting on the 27th April at 7.30pm in Hartfield Village Hall. It is open to all parishioners and you have a chance to publicise your organisation or comment on any issues of interest to you as a Parishioner. We are lucky enough to live in an Area of Outstanding Natural Beauty and this year our speaker is from the High Weald AONB unit speaking about the environment and new partnership schemes. Please note we have changed all our Parish Council Meetings to start at the earlier time of 7.30pm which is in line with the majority of other Wealden parishes. **John Chalke – Chairman Hartfield Parish Council.**

THE HEALTH CENTRE



Hartfield Parish Councillors were very pleased to be invited to attend the ceremony at Old Crown Farm on Monday 23rd February 2009 to mark the commencement of the building of the long awaited new Health Centre in Hartfield Village. We are proud to have been associated with this project from the outset which has involved a lot of lobbying behind the scenes as upon Dr. Furneaux's retirement it was perceived that Hartfield was too small a rural village to retain a medical practice. We are very grateful to Graham Credland of the Primary Care Trust who has driven this project offering unwavering support to Hartfield whilst negotiating a 25 year lease on the land owned by the Trustees of the Witherham Estate who have

owned the land since C1200. The building was designed for the 21st Century under the guidance of Ashley House, experienced medical practice developers and planning permission for the health centre, nine affordable houses, a farm shop and offices was obtained by Complete Land Management who act for the Buckhurst Estate. We are very appreciative of the efforts by Dr. Andrew Wolfle and his team from the Groombridge Practice who have all coped so admirably in cramped temporary conditions. Hartfield Parishioners will be very privileged to have such wonderful facilities on their doorstep. The aim is to be operational in the new premises before Christmas 2009.

NEW INFORMATION WEBSITE (www.veterans-uk.info)



Have you served in the HM Armed Forces? A veteran is anybody who has served in the Armed Forces, regular or reserve including National Servicemen. It is not necessary for Veterans to have served overseas or in conflict. To claim your medal or for free help and advice on almost any matter but largely on statutory benefits, pensions, money worries, loans and grants, emergency accommodation, finding a job, re-training, health issues, welfare concerns, service records and medals ring 0800 169 3377. www.veterans-uk.info

THE OLD COAL YARD “Oyez, Oyez” Good News



We are delighted to announce that after a great deal of concentrated effort, contracts were finally exchanged on the 26th March between Hartfield Parish Council and Town & Country Housing Group who will submit a planning application this month to build nine units of affordable housing on the rear portion of the coal yard. These houses will be for local people who qualify by either having close family ties with Hartfield or who actually work in the Parish. We arranged a special presentation by the Wealden Affordable Housing team at the March Parish Council Meeting however if you missed this you can contact them direct on 01323 443278.

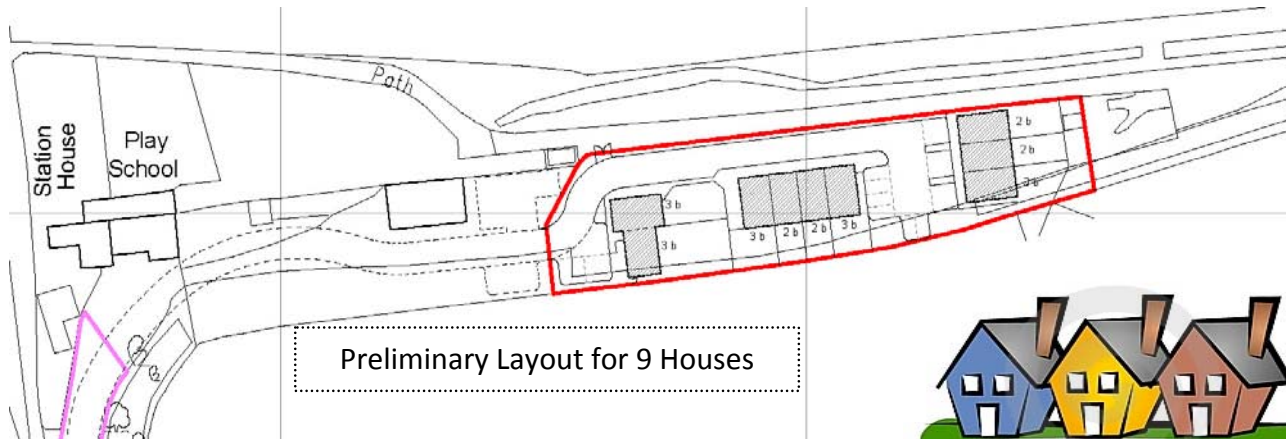

MEMORIAL GARDEN

The harsh winter has taken its toll on some of the plants and others have reached the end of their natural lifespan so in the coming year there will be some re-development work to bring the Memorial Gardens back to their former glory. If any keen gardeners are in the process of splitting up plants that could be suitable for replanting in the



Memorial Garden or would like to make donations towards new plants, please contact Jo Edwards on 01892 770201. Thanks to Graham Scott who cut the grass last year. Mick Argent is now employed for a few hours each fortnight to cut the grass and to carry out some of the heavier jobs but it is hoped that the working party will continue to make a valuable contribution to the upkeep of this beautiful asset in the heart of the village. This season will start on May 9th meeting every second Saturday of the month at 9.30 am in the Memorial Gardens. All are welcome but please come equipped with gardening tools.

Following the achievement of a high silver gilt medal last year, our dedicated coordinator, Sheila van Maurik arranged for an inspiring talk by Peter Holman organiser of the competition and he emphasised it is not just about floral displays but also about community involvement and green issues so as reported in our December Newsletter, Sheila hopes the school can be more involved this year in some of the environmental issues in the planning stages. If you have suggestions or would like to be involved Sheila would be delighted to hear from you on 01892 770273. Please Note: Judging day in Hartfield has just been announced as July 6th.



WEALDLINK COMMUNITY BUS SERVICE

Easylink has now been replaced by WEALDLINK a community bus service that will be operated by Community Transport for the Lewes Area (CTLA) WealdLink will continue to provide a door-to-door shopping service for those who have difficulty accessing other forms of public transport. The timetable and routes will remain unchanged but there is a new phone number **01273 517332** for both registering and booking the service. A charge of £4 per trip per passenger to Crowborough or Tunbridge Wells is made. Additional funding sources are being sought to retain and expand the service.

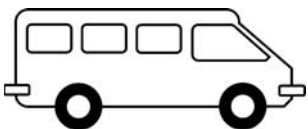

Although it is available to Hartfield parishioners it has up to now been rarely used. Why not give it a try?

SCOOP THE POOP

Despite numerous warning signs irresponsible dog owners are creating health hazards for our children by allowing their pets to foul the grass verges and footpaths near the school and playschool. It is also particularly bad in the Churchyard. If anybody knows the dog owners allowing this to happen they should report them to the Wealden Dog Warden 01323 443555 environmentalprotection@wealden.gov.uk when hopefully they will receive a hefty fine. HPC pay WDC annually for emptying special receptacles to receive such excrement.



HATCH (Hartfield Action Together with Coleman's Hatch)

Hatch was set up following a Church initiative to mark the Millennium, it was a neighbourhood scheme intended to help local people who had unforeseen problems due to illness, infirmity, accident or hardship. Help offered included form filling, relieving carers or offering transport. Fiona Storrs was very much involved in the original setting up and became the first Chairman of the group. Duncan Ball took over this role in 2003. During the period when Hartfield had no surgery in the village, the team of volunteer drivers were kept exceptionally busy, as public transport did not suffice to get to and from Groombridge Surgery. Requests for help still come at a steady but lesser rate, frequently for transport to the surgery, hospital appointments or shopping. These requests are dealt with by a small but dedicated team of Duty Officers who can access the HATCH telephone line from their own home. If you need help or would like to volunteer your services as a driver or man the phone you would be most welcome. Driving expenses are reimbursed and users of transport make a contribution if they are able to do so. The HATCH line 01892 771331 is manned on Monday, Wednesday and Friday between the hours of 9.30 and 11.30am, and at other times you may leave a message on the answer phone & an Officer will get back to you. Please give as much notice as possible.



LUNCH CLUB



For many years a small social group have met each week in Hartfield Village Hall mostly in the Inkpen Room for a chat and a cup of tea. The group mentioned that it would be nice to have lunch together occasionally, & from this remark the Lunch Club was born. This is open to anyone and takes place once every two months in the Village Hall (making use of the excellent upgraded kitchen facilities in the Hall). There is a small charge of £4 (£5 at Christmas) for 2 courses. There is a good variety of food served which is mainly prepared by Enid & James Lambeth who are both excellent cooks. Mary McGlew produces mouth-watering desserts. A team of voluntary helpers cook, serve & clear away. These lunches have become a great social event, involving different age groups, with regular numbers now approaching 50. If you would like an invitation to the next one, please ring the organiser Linda Graham on 01892 770487.

McGlew produces mouth-watering desserts. A team of voluntary helpers cook, serve & clear away. These lunches have become a great social event, involving different age groups, with regular numbers now approaching 50. If you would like an invitation to the next one, please ring the organiser Linda Graham on 01892 770487.

COUNTRY MATTERS FROM OUR TREE WARDEN

Clair Park reported that last year the People's Trust for Endangered Species launched a campaign to identify traditional English orchards. To date approx. 15,000 have been found with the help of aerial photography. They are now seeking volunteers to visit the orchards and record the species, age and condition of the trees. East Sussex is regarded as a priority county with a training event in the summer. Email anita@ptes.org or ring 020 7498 4533 Fun to do especially when the apples are ripe!



PARISH PLAN



At a packed meeting in the Village Hall in February, the Chairman of the Parish Plans team, Doctor Peter Furneaux, presented the draft action plan. He explained how the plan had evolved from public consultation and working parties and asked for any comments to be sent to him or coordinator, Jenny Robinson before the document is published in its final form. The draft plan is still displayed on our website so hurry if you have questions or comments. Please contact either Dr. Furneaux on 01892 770820 or our Parish Clerk on 01342 834409.

BEWARE DEER

There are four types of deer, Fallow, Roe, Muntjac and Sika living in and around the Ashdown forest with the Fallow being by far the most prolific. It seems to be widely accepted that deer numbers continue to increase and distressingly some 300 beautiful creatures per annum are reported as road casualties. Speed does play a part in many accidents so watch for the warning signs and keep to the limits. If you should be unlucky enough to hit and injure a deer you should telephone, the police on 0845 6070.999 **NOT** the Forest rangers. The police will then decide who to call either the registered Deer wardens or the Forest Rangers depending on where the incident occurs. Many people erroneously believe that deer are owned by and under the protection of the Crown, whilst others believe they are owned by the Conservators. Neither is correct. The deer are free spirits and only when dead do they become the property of the land owner where they sadly die.



THE TOWN CROFT – Nancy Holmes

The Town Croft and Parish Assets Committee have been very active forming working parties for cleaning, repairs and maintenance.



Pavilion - Following the exceptionally harsh winter weather burst pipes in the ceiling caused extensive damage to the changing rooms of the pavilion. Builders are now working to restore the facilities but in addition to the insurance money received for basic restoration it was decided to take some of the money from the earmarked reserves for improvements to refurbish the changing rooms to a much higher standard. This will include the installation of some form of heating, powerful showers, referees facilities etc.

Phase 2 should follow shortly which will include disabled loo and a new kitchen. The ambitious plans for new roof, veranda etc. will have to await the receipt of grant funding or be the subject of further serious fundraising.

Youth Hut - Members of the T CPA committee, joined by Chris Simmons have worked really hard in making the Youth Hut clean and presentable again with windows and woodwork repainted, plumbing repaired etc. More work has yet to be done but it is now in a useable state once again.

Bus Shelter. We accepted the lowest quotation to restore and paint the bus shelter at Colemans Hatch. Work should commence this month.

FIRST FOR FUN - Jo Edwarde.

The First Hartfield 10k race and Fun Run got off to a cracking start on 19th April. 52 youngsters set a challenging pace for the Junior 2k race with the first runner back in 9 minutes 20 seconds. Local children were joined by a welcome contingent from Ashdown House School and their Headmaster, who ran an impressive senior race to come 4th. 83 contestants set off for the demanding 10k circuit which climbed up to the phone mast above Ashurst Wood before finishing along the Forest Way and back to Hartfield.



The first contestant home completed the course in 36 minutes and 22 seconds. The barbecue, Bar, Tea and cakes did a roaring trade satisfying the appetites of athletes and family members. This event has exceeded all expectations. It has involved the whole community both young and old and it has been a pleasure to work with so many different sections of the community. We made nearly £1000 for the Hartfield Pavilion Renovation Fund and a huge thank you must go to our sponsors – Central Garage Upper Hartfield, Crowborough Lions Club and Tesco Express. The words “See you next year” were on many lips as families and runners set off for home.

Your Parish Council

Clerk to the Council	MRS. DEBORAH LITTLE	01342 834409	parishclerk@hartfieldonline.com
Chairman of the Parish Council	CLLR. JOHN CHALKE	01892 770540	johnchalke@gmail.com
Vice Chair and Chair of Town Croft & Parish Assets	CLLR. NANCY HOLMES	01892 770294	nancyholmes@btopenworld.com
Chair of Planning	CLLR. CHRIS SIMMONS	01342 850837	
Chair of Rights of Way & Tree Warden	CLLR. CLAIR PARK	01892 770326	clairpark@btinternet.com
Chair of Environment & Transport	CLLR. MIKE BURBRIDGE	01892 770919	mike.burbridge@googlemail.com
Chair of Playgroup Trustees	CLLR. JO EDWARDE	01892 770201	joedwarde@hotmail.com
	CLLR. PETER CRANE	01424 736961	peter.crane@sky.com
	CLLR. KEVIN HAWES	01342 825827	kevin_hawes@talktalk.net
	CLLR. ANNE HIGGINS	01892 770312	annehigginshartfield@hotmail.com
	CLLR. GEORGE KORBEL	01342 822720	george@uni-com.uk.com
	CLLR. TOM MITCHELL	01892 770227	
	CLLR. JOHN SMITH	01892 770871	cidercentre@aol.com
	CLLR. SHEILA van MAURIK	01892 770273	
WEALDEN DISTRICT CLLR. (Hartfield Ward)	CLLR. MICHAEL HOY	01892 770166	michael.hoy@wealden.gov.uk
WEALDEN DISTRICT CLLR. (Holtye Ward)	CLLR. DAVID JONAS	01342 826144	david.jonas@wealden.gov.uk
EAST SUSSEX COUNTY CLLR.	CLLR. FRANCIS WHETSTONE	01892 770304	franciswhetstone@eastsussex.gov.uk

Other useful numbers

Wealden District Council 01892 653311
Local Police Community Support Officer
karen.juniper@sussex.pnn.police.uk

East Sussex County Council 01273 481000
Karen Juniper 0845 6070999 – Ext. 19463
Emergencies as usual 999 or 112

It was disappointing to learn at the April PC meeting that WDC will not be implementing doorstep recycling until the first quarter of 2010



Newsletter Coordinator – Cllr. Nancy Holmes
© Hartfield Parish Council December 2008.

Printed by EMS Ltd. Medway House 18-22 Cantelupe Road East Grinstead RH19 3BJ 01342 323700

www.hartfieldonline.com